

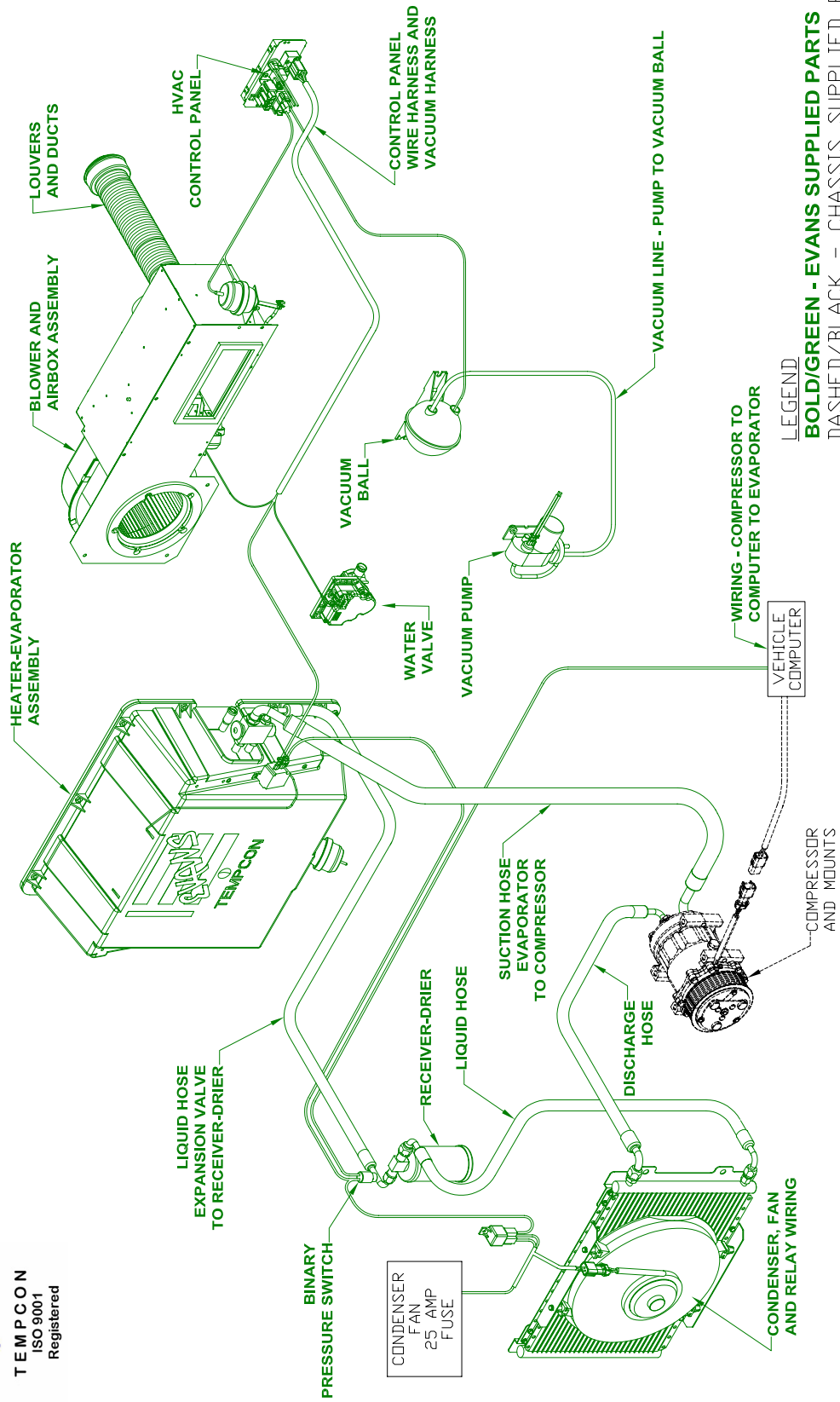

TEMPCON
ISO 9001
Registered

TYPICAL PUSHER CHASSIS WITHOUT FACTORY SUPPLIED A/C PARTS VERSUS EVANS SUPPLIED PARTS



Note: On Workhorse Pusher there is a high pressure switch mounted at the compressor supplied with chassis.



TEMPCON
ISO 9001
Registered

TYPICAL PUSHER CHASSIS WITH FACTORY SUPPLIED A/C PARTS VERSUS EVANS SUPPLIED PARTS

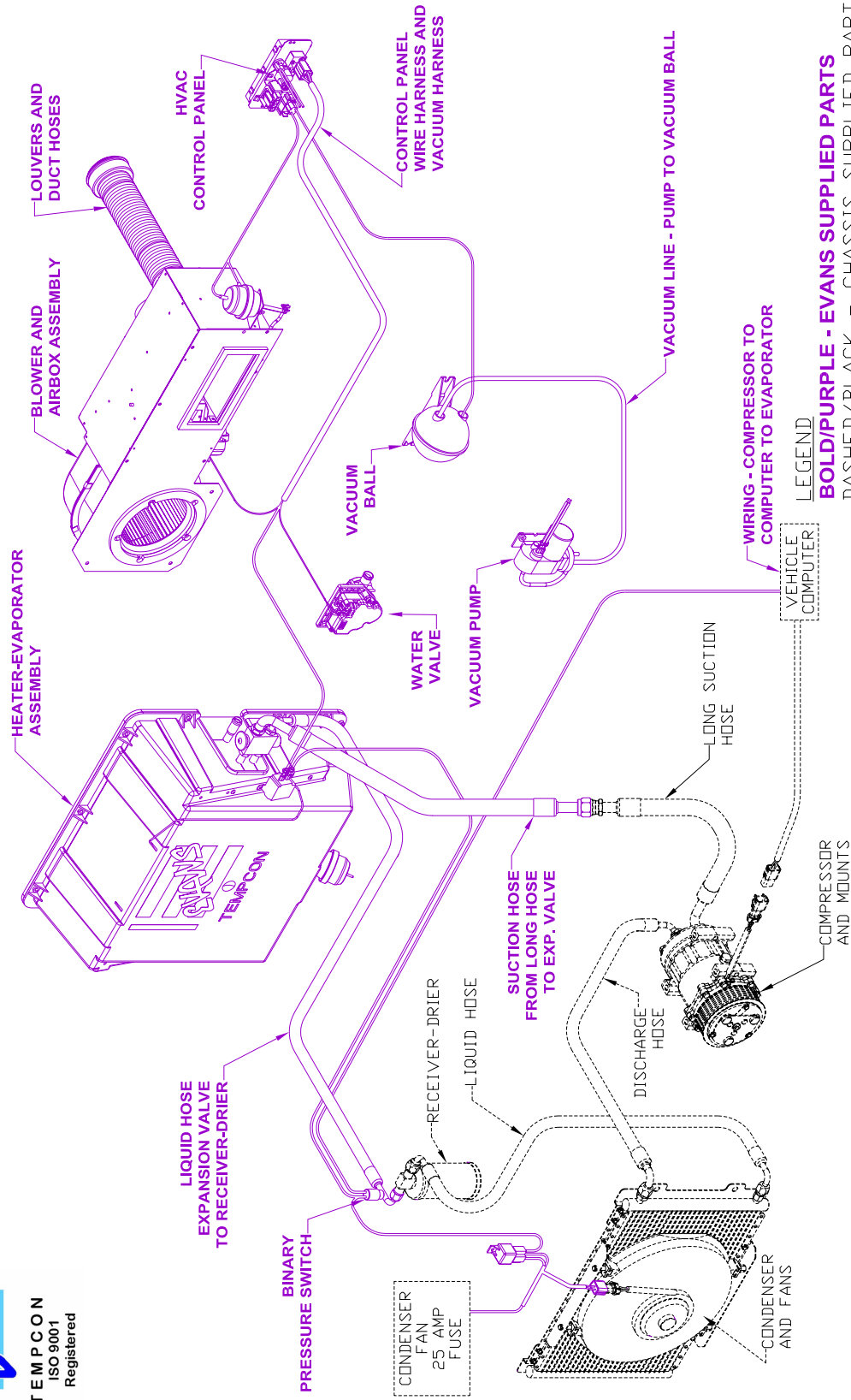

NOTE: On Freightliner and Spartan side radiator/condensers, the pressure switch on the discharge hose that controls the hydraulic fan is chassis supplied. Chassis computer must be enabled to use this switch. There is no Evans supplied electric fan. On Workhorse Pusher there is a high pressure switch at the compressor supplied with chassis.



TEMPCON
ISO 9001
Registered

2005 M.Y. AND BEYOND WORKHORSE FRONT GAS CHASSIS SUPPLIED PARTS VERSUS EVANS SUPPLIED PARTS

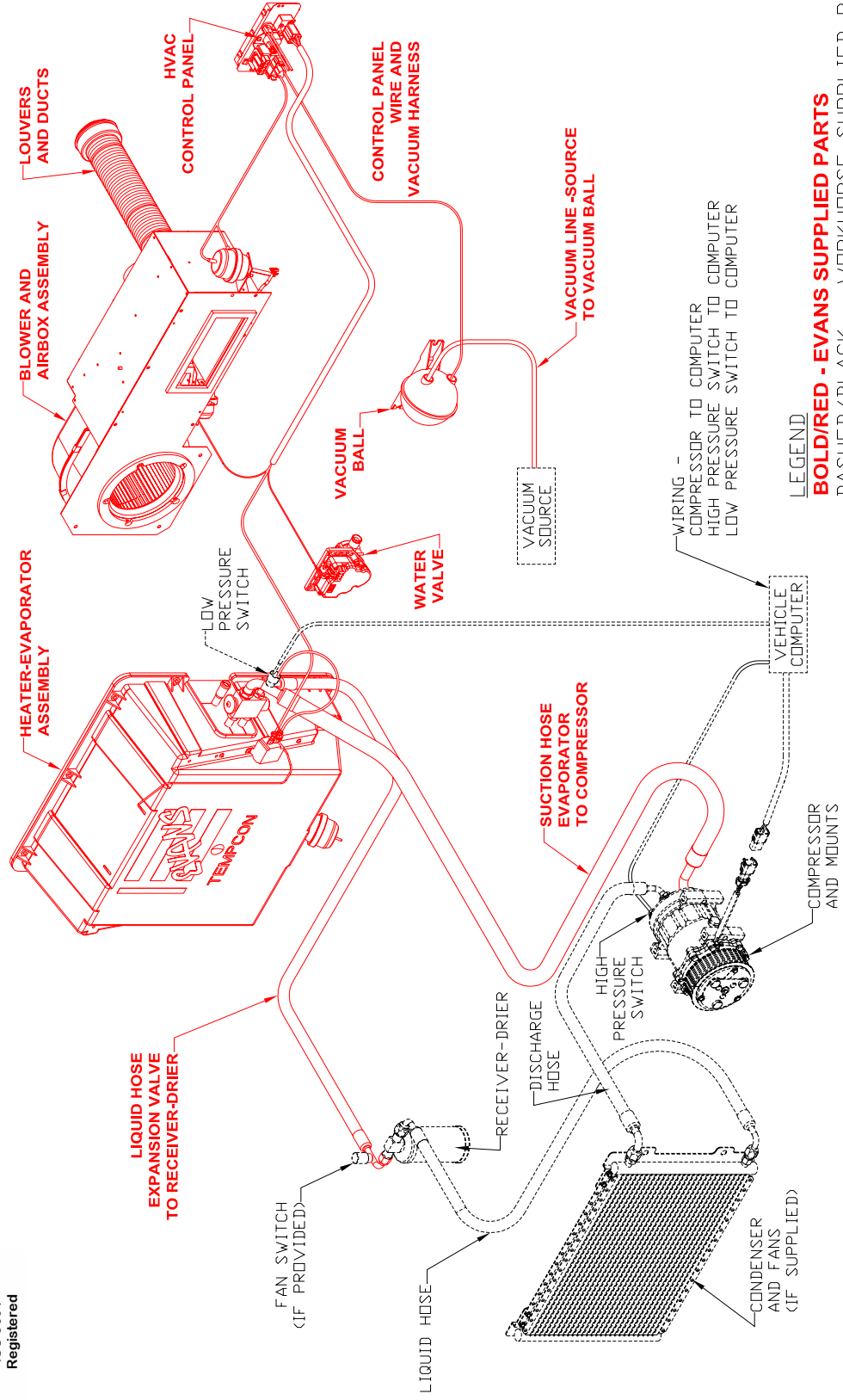



TEMPCON
ISO 9001
Registered

2005 M.Y. CHASSIS AND BEYOND FORD CHASSIS SUPPLIED PARTS VERSUS EVANS SUPPLIED PARTS

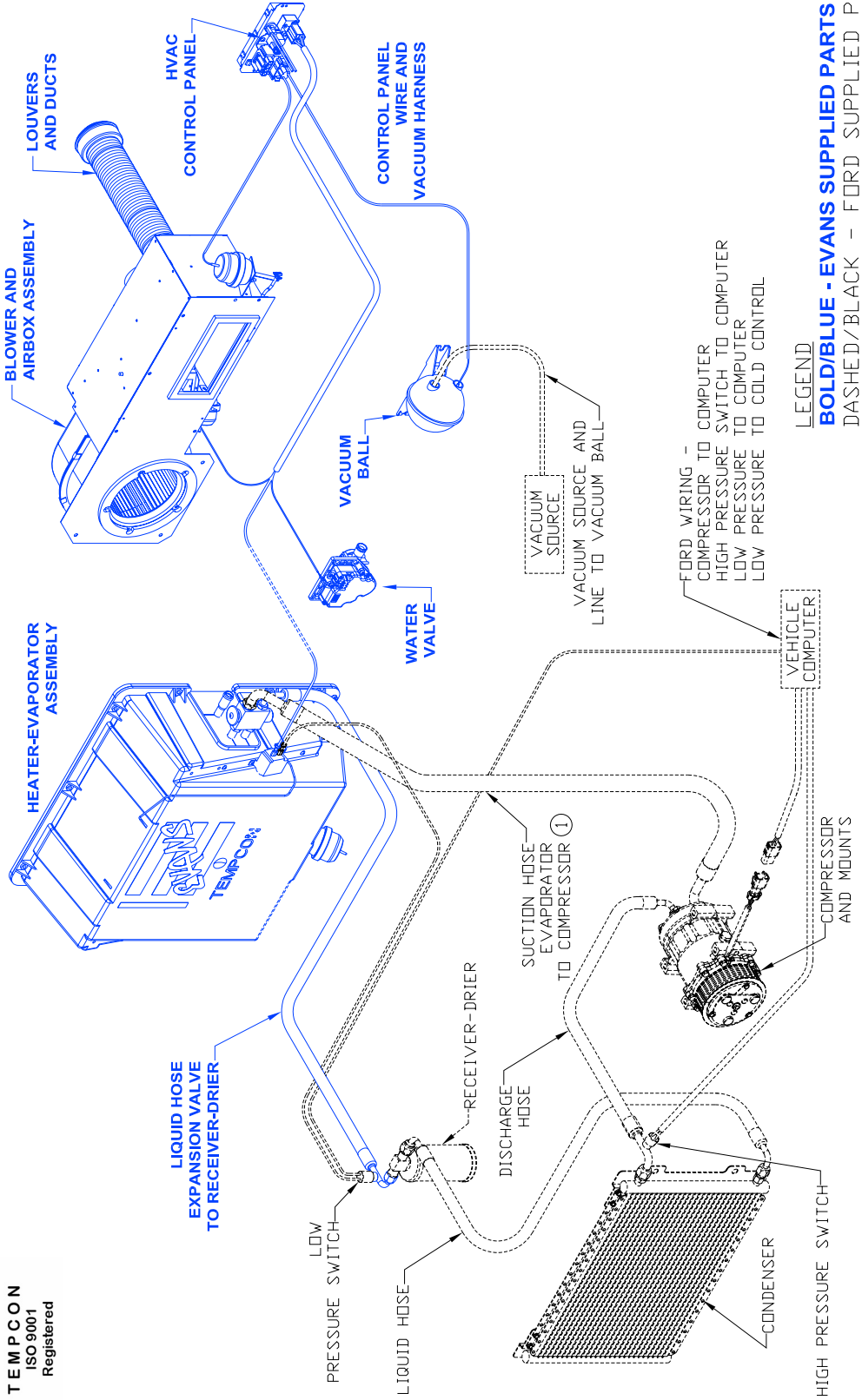

1. Gulfstream: After May, 2006 this part is Evans supplied.